

Dev
7

- KEY**
- Absolutely necessary ————
 - Especially important - - - -
 - Important - . - . - .
 - Undesirable

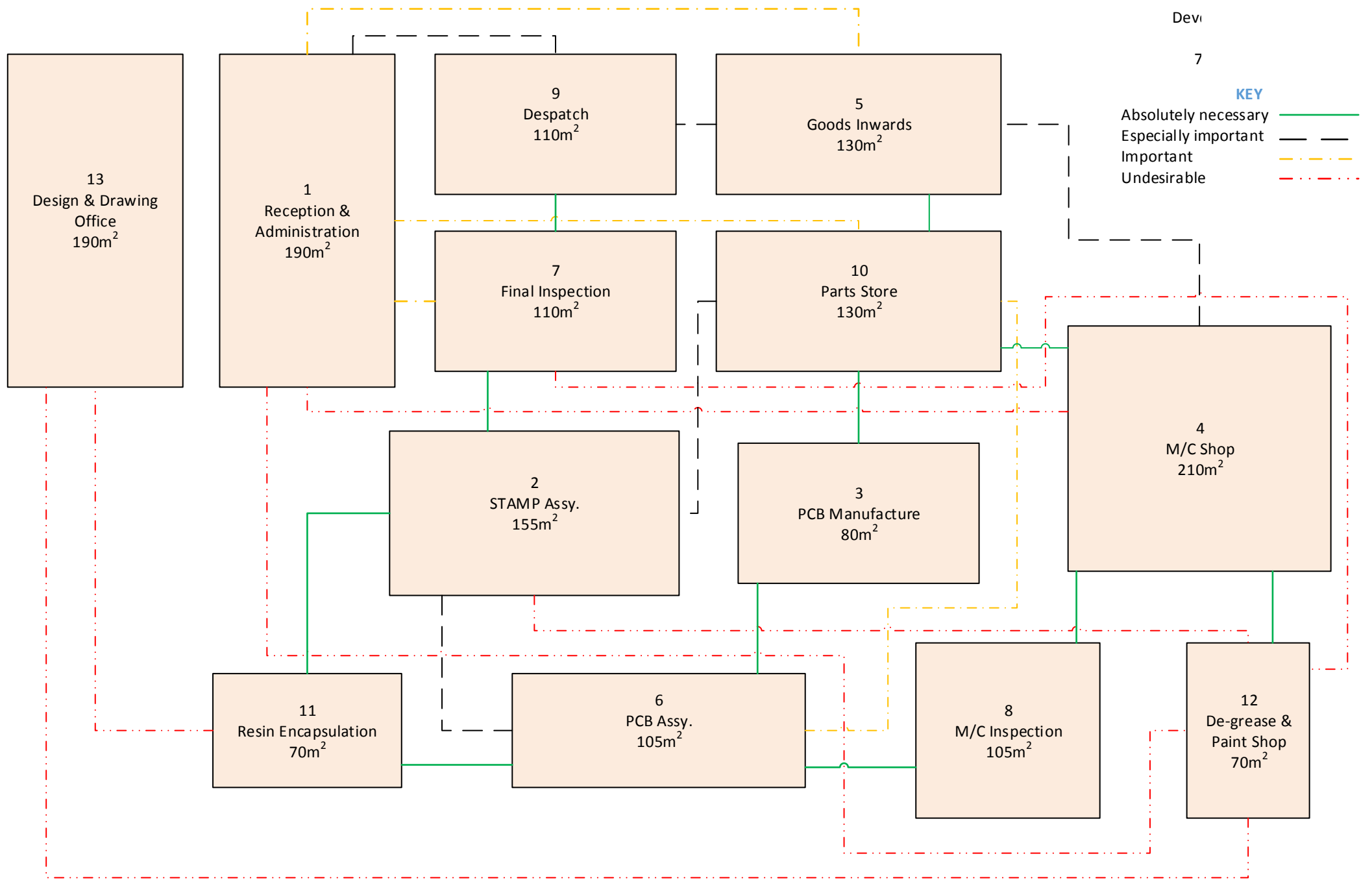

Dev:
7

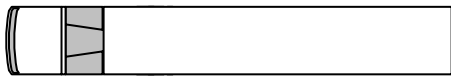

Access Road



55m

15m

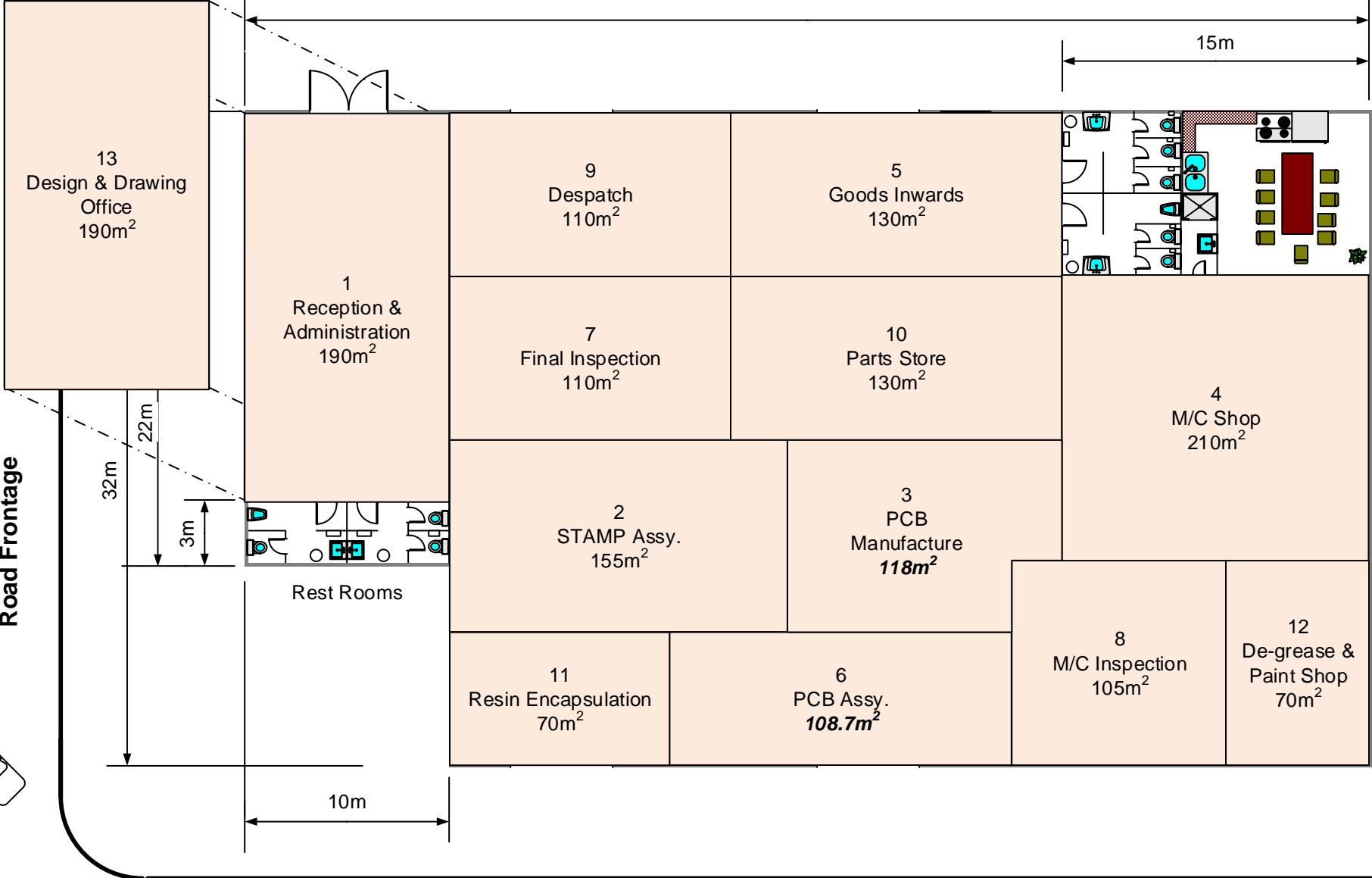

Team detectors Ltd.

Site of proposed new plant .

Notes:

- 1. Concrete hard-standing all round building.
- 2. Locations of rest-rooms and lunch room cannot be moved because of drainage issues.
- 3. Existing openings may be closed or moved if essential but it is expensive and is not preferred.

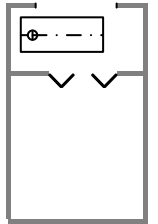

Dangerous Goods store

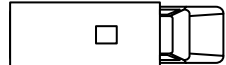
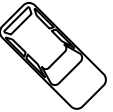

Access Road